

Licensing Panel (Licensing Act 2003 Functions)

Date: **18 May 2021**

Time: **10.00am**

Venue **Virtual**

Note: in response to current Government Regulations this meeting is being held as a virtual meeting for councillors and accessible via Teams. Public speaking and engagement opportunities will be made available.

Members: **Councillors:**, Deane, O'Quinn and Simson

Contact: **Penny Jennings**
Democratic Services Apprentice
01273 291065
penny.jennings@brighton-hove.gov.uk

Agendas and minutes are published on the council's website www.brighton-hove.gov.uk.
Agendas are available to view five working days prior to the meeting date.

Electronic agendas can also be accessed through our meetings app available through ModernGov: [iOS/Windows/Android](#)

This agenda and all accompanying reports are printed on recycled paper

AGENDA

1 TO APPOINT A CHAIR FOR THE MEETING

WELCOME & INTRODUCTIONS

2 PROCEDURAL BUSINESS

(a) **Declaration of Substitutes:** Where Councillors are unable to attend a meeting, a substitute Member from the Licensing Committee may attend, speak and vote in their place for that meeting.

(b) **Declarations of Interest:**

- (a) Disclosable pecuniary interests;
- (b) Any other interests required to be registered under the local code;
- (c) Any other general interest as a result of which a decision on the matter might reasonably be regarded as affecting you or a partner more than a majority of other people or businesses in the ward/s affected by the decision.

In each case, you need to declare

- (i) the item on the agenda the interest relates to;
- (ii) the nature of the interest; and
- (iii) whether it is a disclosable pecuniary interest or some other interest.

If unsure, Members should seek advice from the committee lawyer or administrator preferably before the meeting.

(c) **Exclusion of Press and Public:** To consider whether, in view of the nature of the business to be transacted, or the nature of the proceedings, the press and public should be excluded from the meeting when any of the following items are under consideration.

NOTE: Any item appearing in Part Two of the Agenda states in its heading the category under which the information disclosed in the report is exempt from disclosure and therefore not available to the public.

A list and description of the exempt categories is available for public inspection at Brighton and Hove Town Halls.

3 66 LEWES ROAD LICENSING PANEL (LICENSING ACT 2003 FUNCTIONS)

7 - 36

Report of the Executive Director of Housing, Neighbourhoods and Communities (copy attached)

Contact Officer: Donna Lynsdale

Tel: 01273 292494

Ward Affected: St Peter's & North Laine

The City Council actively welcomes members of the public and the press to attend its meetings and holds as many of its meetings as possible in public. Provision is also made on the agendas for public questions to committees and details of how questions can be raised can be found on the website and/or on agendas for the meetings.

The closing date for receipt of public questions and deputations for the next meeting is 12 noon on the fourth working day before the meeting.

Meeting papers can be provided, on request, in large print, in Braille, on audio tape or on disc, or translated into any other language as requested. Infra-red hearing aids are available for use during the meeting. If you require any further information or assistance, please contact the receptionist on arrival.

FURTHER INFORMATION

For further details and general enquiries about this meeting contact Thomas Bald, (01273 291065, email penny.jennings@brighton-hove.gov.uk) or email democratic.services@brighton-hove.gov.uk

WEBCASTING NOTICE

This meeting may be filmed for live or subsequent broadcast via the Council's website. At the start of the meeting the Chair will confirm if all or part of the meeting is being filmed. You should be aware that the Council is a Data Controller under the Data Protection Act 1998. Data collected during this web cast will be retained in accordance with the Council's published policy.

Therefore, by entering the meeting room and using the seats in the chamber you are deemed to be consenting to being filmed and to the possible use of those images and sound recordings for the purpose of web casting and/or Member training. If members of the public do not wish to have their image captured, they should sit in the public gallery area.

ACCESS NOTICE

The Public Gallery is situated on the first floor of the Town Hall and is limited in size but does have 2 spaces designated for wheelchair users. The lift cannot be used in an emergency. Evac Chairs are available for self-transfer and you are requested to inform Reception prior to going up to the Public Gallery. **For your own safety please do not go beyond the Ground Floor if you are unable to use the stairs.**

Please inform staff on Reception of this affects you so that you can be directed to the Council Chamber where you can watch the meeting or if you need to take part in the proceedings e.g. because you have submitted a public question.

FIRE / EMERGENCY EVACUATION PROCEDURE

If the fire alarm sounds continuously, or if you are instructed to do so, you must leave the building by the nearest available exit. You will be directed to the nearest exit by council staff. It is vital that you follow their instructions:

- You should proceed calmly; do not run and do not use the lifts;
- Do not stop to collect personal belongings;
- Once you are outside, please do not wait immediately next to the building, but move some distance away and await further instructions; and
- Do not re-enter the building until told that it is safe to do so.

**LICENSING PANEL
(Licensing Act 2003 Functions)**

Agenda Item

Brighton & Hove City Council

Subject:	Application for a New Premises Licence under the Licensing Act 2003		
Premises:	66 Lewes Road Brighton BN2 3HZ		
Applicant:	Esra Baser		
Date of Meeting:	18 May 2021		
Report of:	Executive Director of Housing, Neighbourhoods & Communities		
Contact Officer:	Name:	Donna Lynsdale	Tel: (01273) 292494
	Email:	donna.lynsdale@brighton-hove.gov.uk	
Ward(s) affected:	St. Peter's And North Laine		

FOR GENERAL RELEASE

1. PURPOSE OF REPORT AND POLICY CONTEXT

- 1.1 To determine an application for a New Premises Licence under the Licensing Act 2003 for 66 Lewes Road.

2. RECOMMENDATIONS:

- 2.1 That the Panel determine an application for a New Premises Licence under the Licensing Act 2003 for 66 Lewes Road.

3. CONTEXT/BACKGROUND INFORMATION & CONSULTATION

- 3.1 The application is for a New Premises Licence under the Licensing Act 2003. The application proposes a new premises licence for an off licence.
- 3.2 Section 18 (operating schedule) of the application is detailed at Appendix A and the plan of the premises is attached at Appendix B.

3.3 Summary table of proposed activities

	Proposed
Supply of Alcohol	Sunday – Thursday 09:00 – 23:00 Friday – Saturday 09:00 to 23:30
Hours premises are open to public	Sunday – Thursday 09:00 – 23:00 Friday – Saturday 09:00 to 23:30

3.4 Special Stress Area: The premises falls within the Special Stress Area. This area is deemed an area of special concern in terms of the levels of crime, disorder, and public nuisance experienced within them. (See paragraphs 3.2 – 3.2.5)

Representations received

- 3.5 Details of the representations made are notified to applicants on receipt by the Licensing Authority using a pro-forma. A summary appears below:
- 3.6 Two representations were received. They were received from Sussex Police and The Licensing Authority.
- 3.7 Representations received had concerns relating to Prevention of Crime and Disorder, Prevention of Public Nuisance & Protection of Children from Harm.
- 3.8 Full details of the representations are attached at Appendix C. A map detailing the location of the premises is attached at Appendix D.

4. COMMENTARY ON THE LICENSING POLICY

4.1 The following extracts from Brighton & Hove City Council Statement of Licensing Policy are considered relevant to this application and **are numbered as they appear in the policy**:

1 Introduction

1.1 This Statement of Licensing Policy has been prepared in accordance with the provisions of the Licensing Act 2003 (the Act) and having regard to Guidance issued by the Home Office under Section 182 of the act. This policy takes effect from the 4th February 2021. The licensing authority is Brighton & Hove City Council. The purpose of this statement is to promote the licensing objectives and set out a general approach to making licensing decisions. The discretion of the licensing authority in relation to applications under the act is only engaged if 'relevant representations' are made by other persons or responsible authorities. This policy will inform the approach to be taken when deciding applications and imposing conditions when relevant representations are received. It is also intended as a guide for

applicants as to what to include in their operating schedules, always recognising that if no representations are received, the application must be granted. The licensing authority must carry out its functions with a view to promoting the licensing objectives and this policy is framed around those objectives. Each application will be given individual consideration on its merit. The scope of this policy covers the following:

- Retail sales of alcohol.
- The supply of alcohol by or on behalf of a club, or to the order of, a member of the club.
- The provision of regulated entertainment.
- The provision of late night refreshment.

1.2 The licensing objectives are:

- (a) the prevention of crime and disorder.
- (b) public safety.
- (c) the prevention of public nuisance; and
- (d) the protection of children from harm.

1.3 Scope

- 1.3.1 Licensing is about regulating licensable activities on licensed premises, by qualifying clubs and at temporary events. Any conditions attached to various authorisations will be focused on matters which are within the control of individual licensees and others with relevant authorisations, i.e. the premises and its vicinity. Each application will be given individual consideration on its merit. Nothing in this policy shall undermine the right of any individual to apply under the terms of the act for a variety of permissions and to have any such application considered on its individual merits. Similarly, nothing in this policy shall override the right of any person to make representations on an application or seek a review of a licence or certificate where provision has been made for them to do so in the act.

3 Special Policies and Initiatives

3.2 Special Stress Area

- 3.2.1 The map below details the area of the city centre which borders the Cumulative Impact zone at 3.1.3 and which is deemed an area of special concern in terms of the levels of crime and disorder and public nuisance experienced within it. The area recommended for further monitoring and detailed guidance within the Special Policy comprise the following as pictured below delineated in purple:

Special Stress Area and Cumulative Impact Zone, January 2021

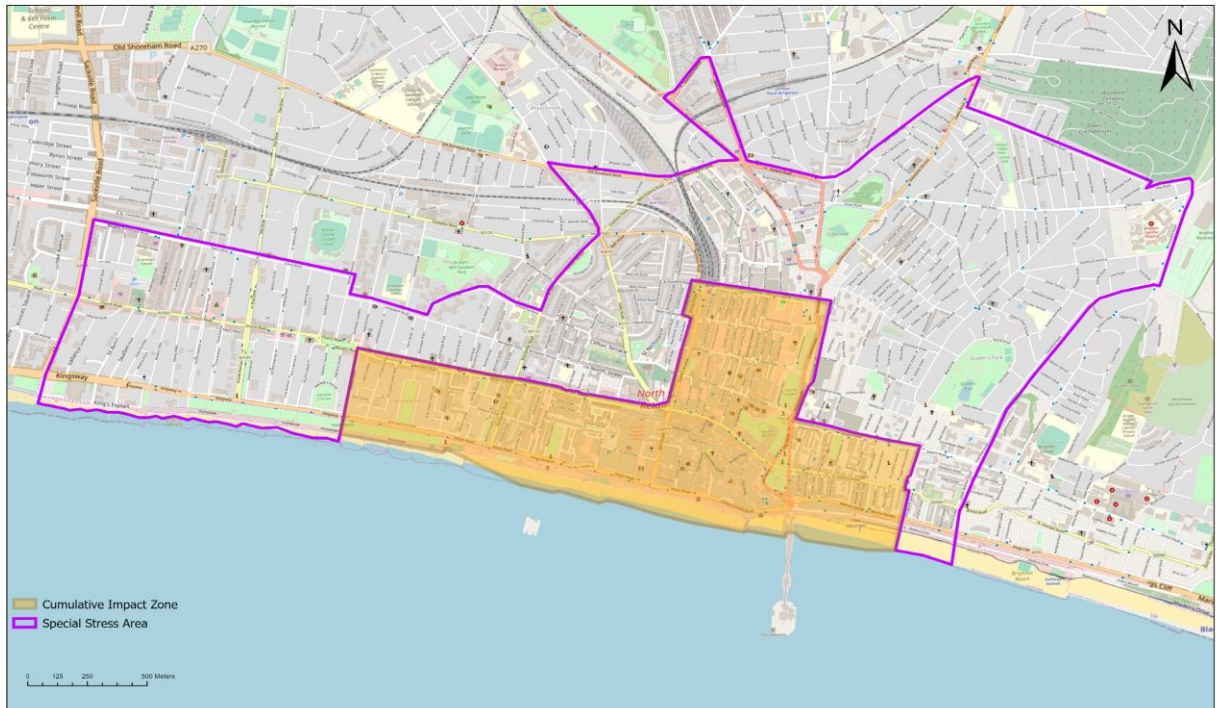

© OpenStreetMap (and) contributors, CC-BY-SA © Crown Copyright. All rights reserved. Licence: 100020999. Brighton & Hove City Council. 2019. Cities Revealed © 2018 Brighton & Hove Public Health Intelligence, 2021

The Special Stress Area - an area bounded by and including: The west side of Hove Street/Sackville Road, northwards to the intersection with the north side of Blatchington Road, along north side of Blatchington Road and Eaton Road, southwards at the junction onto the east side of Palmeira Avenue and then eastwards at the junction onto the north side of Landsdowne Road; eastwards to the junction with Furze Hill, along the north side Furze Hill to its end and then due east along the north side of Victoria Road to its junction with Montpelier Road (west side), north to where Montpelier Road joins Vernon Terrace then north to Seven Dials; north west along the west side of Dyke Road until the junction with the Old Shoreham Road, then East along the north side of Old Shoreham Road, continuing on the north end of New England Road, north west at Preston Circus at the junction of New England Road and Preston Road along the west side of Preston Road until the junction with Stanford Avenue then and north east along the north side of Stanford Avenue until the junction with Beaconsfield Road, south along the east side of Beaconsfield Road until the junction at Preston Circus and Viaduct Road, eastwards along the north side of Viaduct Road, then at the junction with Ditchling Road, North East along the north side of Upper Lewes Road until the junction with Lewes Road; south along the Lewes Road to junction with Hartington Road, along the north side of Hartington Road until the junction with St. Helen's Road, south into the north side of May Road, eastwards until its junction with Freshfield Road (east side), then south into Upper Bedford Street, into Bedford Street to the mean water mark south of Bedford Street, then due west until the mean water mark south of Lower Rock Gardens; North on Upper Rock gardens, to the north side of Eastern Road, west along Eastern Road and Edward Street until Grand Parade, north along the Eastern side of Grand Parade to the junction of York Place and Trafalgar Street, West along the Northern boundary of Trafalgar Street, up to and including Surrey Street and then South along the Western boundary of Queens Road to the junction with Air Street, West along the north side of Air Street, South-west to the junction of

Western Road Brighton, then West along the North side of Western Road Brighton, South along the West side of Holland Road to the mean water mark south of Kingsway and Kingsway Esplanade as far as the west side of Hove Street/ Sackville Road.

- 3.2.2 This Special Stress Area (SSA) is of concern to the licensing authority because of the relatively high levels of crime and disorder and nuisance experienced within it. The area will be kept under review.
- 3.2.3 New and varied applications for premises and club premises certificates within the SSA will not be subject to the presumption of refusal, but operators will be expected to pay special attention when drawing up their operating schedules and to make positive proposals to ensure that their operation will not add to the problems faced in these areas. Appendix A of the SoLP sets out a list of potential measures the licensing authority considers may be appropriate. These may be more or less appropriate depending upon the style of operation applied for.
- 3.2.4 On receipt of any application in the SSA, where a relevant representation has been made, the licensing authority will scrutinise the application carefully and will look at the measures proposed in the operating schedules and compare them to the measures set out in Appendix A, Licensing Best Practice Measures. Where discretion has been engaged, those applications which fall short may be refused or conditions applied to comply with policy measures.
- 3.2.5 The Licensing Authority will keep the Cumulative Impact Zone and Special Stress Area under review. Should the authority find that problems of crime and disorder or nuisance are not improving, or are worsening, the Special Policy will be reviewed.

3.3 The Matrix Approach

The Licensing Authority will support:

- 3.3.1 Diversity of premises: ensures that there is a mix of the different types of licensed premises and attracts a more diverse range of customers from different age groups, different communities and with different attitudes to alcohol consumption. It gives potential for positively changing the ambience of the city or an area of it. This will have a positive effect in reducing people's fear of crime and in increasing the number of evening visitors to the city centre. The Community Safety Strategy recognises that too many single uses in a confined area and patrons turning out onto the streets at the same time may create opportunities for violent crime and public disorder and therefore supports mixed use venues encouraging a wider age balance.
- 3.3.2 A "matrix" approach to licensing decisions has been adopted and is set out below. It provides a framework of what the licensing authority would like to see within its area and gives an indication of the likelihood of success or otherwise to investor and businesses making applications.

Matrix approach for licensing decisions in a Statement of Licensing Policy (times relates to licensable activities).

	Cumulative Impact Area	Special Stress Area	Other Areas
Restaurant	Yes (midnight)	Yes (midnight)	Yes (midnight)
Café	Yes (10 pm)	Yes (10 pm)	Yes (10 pm)
Late Night Takeaways	No	Yes (midnight)	Yes (midnight)
Night Club	No	No	No
Pub	No	Yes (11pm)	Yes (midnight)
Non-alcohol lead (e.g. Theatre)	Yes (favourable)	Yes (favourable)	Yes (favourable)
Off-licence	No	No	Yes (Up to 11pm but if in densely residential area may be earlier – see note 7 below)
Members Club (club premises certificate)	Yes (<100 capacity) (11pm)	Yes (<100 capacity) (11pm)	Yes

Notes on matrix

Subject to the following notes, the policy, as represented in the matrix, will be strictly adhered to:

- 1) Each application will be considered on individual merit
- 2) Applications within the CIZ are subject to the special policy on cumulative impact at para 3.1, and those within the special stress area to the special stress policy considerations at para 3.2.
- 3) Departure from the matrix policy is expected only in exceptional circumstances
- 4) Exceptional circumstances will not include quality of management or size of venue except where explicitly stated in policy matrix.
- 5) Exceptional circumstances may include consultation with and meeting requirements of responsible authorities, an appropriate corporate social responsibility policy, community contribution to offset impact (such as financial contribution to infrastructure), community support, alcohol sale ancillary to business activity (demonstrable to responsible authorities and licensing

authority, for instance by licence condition allowing authorised officers access to sales accounts).

- 6) The following licensing activities are encouraged and valued by the licensing authority: outdoor regulated entertainment, community based street parties, members clubs, traditional pubs outside the city centre and non-alcohol led licensable activities, particularly within city centre.
- 7) Other Areas; consideration will be given to the nature of the area and location in relation to any application. In a residential area for example the concerns of local residents will be relevant when considering applications for off-licences, pubs or cafes, especially if there is evidence of anti-social behaviour, street drinking or underage drinking. Earlier closing times may be appropriate. Regard will be had to the Public Health Framework for assessing alcohol licensing on our website www.brighton-hove.gov.uk/licensingact.
- 8) In an area where there are already several existing off-licences or where the premises is situated within a parade with another off licence and where representations are received about negative cumulative impact on the licensing objectives of a further premises, the application may be refused on these grounds or restrictions placed on the terminal hour to reflect opening hours of other shops.
- 9) Outdoor events will be supported where arranged through the council's event planning process. Generally, regulated entertainment in the open-air including tents and marquees should have a maximum closure hour of 2300. Earlier hours may be imposed in sensitive open spaces or near residential areas. The licensing authority will have regard to Noise Council guidance.
- 10) Non-alcohol led category does not include "alcohol in shared workplaces". It is recommended that sale of alcohol in shared workspaces should have a terminal hour of no later than 10pm. For further advice and guidance on "alcohol in shared workplaces" please see paragraph 3.3.4-3.3.6.

3.5 Off licences

In recent years there has been a noticeable shift towards more people buying alcohol from shops and drinking at home prior to going into premises such as pubs and clubs. The council is concerned that alcohol loading from off-licence sales is a significant problem in the city and adversely affects the licensing objectives as it gives rise to problems of drunkenness, disorderly behaviour and a higher risk of alcohol sales to children. Representations from the police, local residents and the director of public health at licensing panel hearings have testified to these problems and Information published in the Public Health Framework for assessing alcohol licensing presents a ward by ward analysis of crime and disorder and health data which is relevant in this respect.

- 3.5.1 The special policy on cumulative impact and the special stress areas apply to off licences as explained in the matrix approach at 3.3. But in general, where applications are made for new premises or variations to existing licences, and where the police or others make representations against the

grant of a further licence for off sales, the council will give specific consideration to restricting the number, type, and the hours of premises selling alcohol exclusively for consumption off the premises. Decisions will be grounded in the Public Health Framework for assessing alcohol licensing. The council will want to be assured that the operating schedule of premises, and their overall management, training and levels of staffing, are appropriate to ensure that the licensing objectives are promoted in what may be challenging circumstances. Retail outlets and stores where the provision of fresh produce is the principal product sold maybe considered more favourably.

3.5.2 The Licensing Authority encourage off licences to join the Council led “Sensible on Strength” scheme to reduce the availability of cheap super strength beers and ciders. Off licences voluntarily sign up not to sell cheap super-strength beers and ciders over 6% ABV and operate good practice measures (see 3.5.3) for which they receive an accreditation as a responsible retailer.

3.5.3 Areas of best practice that may be included in an Operating Schedule include:

- the installation of a digital CCTV system by liaison with, and to a standard approved by Sussex Police
- Challenge 25 policy
- Refusals system
- Documented staff training including underage sales, drunkenness and proxy sales
- Voluntary restriction of high strength alcohol - operating schedules may be used to limit high ABV beers and ciders
- BCRP membership (or other accredited scheme)
- No sale of single cans
- Displays should not be located at the entrance/exit points or near checks out

3.5.4 The Licensing Authority and Sussex Police have specific concerns around the delivery of alcohol off the premises due to issues around the end location of delivery, age verification checks (Challenge 25), the increased possibility of the alcohol coming into the CIZ and SSA from other areas, as well as the personal safety of drivers when having to refuse a delivery at the end destination.

3.5.5 Alcohol delivery poses a unique set of challenges as it often transfers the final age verification to a person who has no responsibility in relation to the Premises Licence which authorised the sale of alcohol. A premises licence holder needs to be satisfied that their drivers or the delivery drivers of the third-party company they chose to use, have received regular and comprehensive training in age verification and identifying persons who have consumed too much alcohol.

- 3.5.6 Evidence has shown that customers have previously used landmarks/businesses not related to them as addresses for delivery so that alcohol could be consumed in open spaces/parks. The risk being that this may lead to increased crime and disorder including anti-social behaviour and criminal damage, as well as the possibility that underage persons can gain access to alcohol. Concerns have also been raised about the delivery of alcohol to known street drinking hotspots. Therefore, a condition requiring all deliveries to be to a verifiable residential or business address and a face to face ID verification is vital in mitigating some of this risk.
- 3.5.7 While the Licensing Authority and Sussex Police recognise this is a growing area of business, new or variation applications to include the delivery of alcohol off the premises will be subject to increased scrutiny. Suggested conditions for the provision of an alcohol delivery service can be found at Appendix A. These are not exhaustive and each application will be considered on its own merits.

3.6 Street drinking

- 3.6.1 The Licensing Authority will have regard to areas highlighted by Sussex Police that are at risk from alcohol related anti-social behaviour. The nature of these areas can be fluid/seasonal and so updated maps and data will be produced regularly to ensure the information is current. These hot spot areas are considered high risk for street drinkers and the Licensing Authority will have regard to prevention of crime and disorder by virtue of street drinking and anti-social behaviour when considering applications in this area.

4 Prevention of Crime and Disorder

The following details and measures are intended to address the need for the prevention of crime and disorder which may be associated with licensed premises and certificated club premises. Conditions attached to licences and certificates will, as far as possible, reflect local crime reduction strategies.

- 4.1.1 The licensing authority acknowledges that training and good management play a key part in preventing alcohol and drug related crime. The authority expects that all licensees of on-licensed premises attend training programmes which will raise their awareness of the issues relating to drugs and violence in licensed premises, and that suitable training be extended to all bar staff and door supervisors so that drug dealers and users will be deterred from using licensed premises for illegal purposes and that incidents of violence in licensed premises will be reduced. Licensees are also encouraged to attend training programmes to help identify children at risk and issues of basic child protection. It is the duty of the designated premises supervisor (DPS) to train staff on induction concerning conditions on their premises licence.

4.1.2 It is expected that the DPS will spend a significant amount of time on the premises. When not on the premises it will be essential that the DPS is contactable, particularly should problems arise with the premises and that staff are authorised by the DPS.

4.1.3 The location of violent attacks, anti-social behaviour and hate crime or related incidents may be used to justify closing times.

4.2 **Care, control and supervision of premises**

4.3.1 The Licensing authority supports the Business Crime Reduction Partnership and other approved schemes. Where appropriate, premises licence holders should be members of the BCRP for the deterrence to violent crime that such membership provides. The BCRP NightSafe radio scheme is normally expected as an operational requirement for city centre bars, clubs and pubs and is an example of good practice in achieving the aim of reducing crime and disorder and improving public safety. Well managed pub-watch schemes provide information exchange between the premises licence holders and responsible authorities that reduce and deter violent crime and disorder. The council will support a responsible licensing scheme.

4.3.2 The effective management and supervision of a venue is a key factor in reducing crime and disorder, both within it and outside. The police will consider the applicants, objecting to the application where appropriate. The police may suggest crime prevention measures in relation to, for example, the internal layout of the premises, closed-circuit television, help points, lighting and security staff. The police may ask for conditions which support such measures to be imposed when licensing applications are granted, e.g. type of licence, capacity, operating hours restrictions.

4.3.3 Following the grant of a licence, the management and supervision of the premises, in so far as it might impact on crime and disorder, will continue to be monitored. Particular attention will be paid to any licensed premises where there is evidence of criminal activity or any association with racist or homophobic crime. The licensing authority will keep itself well briefed on the nature, location and type of premises where alcohol related violence and disorder are occurring so it can take full account of the facts and avoid exacerbating problems as required by the Community Safety Strategy. Where licensed premises are found to cause nuisance or be associated with disorder or unreasonable disturbance, the review process may be invoked, and powers of revocation or the imposition of conditions may be considered. Conditions may include use of closed-circuit television, licensed door supervisors and earlier closing times. Such action to restrict the operation may be taken for trial periods to allow businesses an opportunity to remedy existing disorder, nuisance or disturbance.

6 Prevention of Public Nuisance

The following details and measures are intended to address the need for the prevention of public nuisance which may be associated with licensed premises and certificated club premises:

- 6.1.1 In determining applications for new and varied licences, regard will be had to the location of premises, the type and construction of the building and the likelihood of nuisance and disturbance to the amenity of nearby residents by reason of noise from within the premises, as a result of people entering or leaving the premises or from individuals or groups of customers gathered outside (e.g. in order to smoke).
- 6.1.6 Reasonable controls are available to all premises operators to minimise the impact of noise from customers outside. The council's Environmental Health Department has issued guidance on a number of steps that can be taken in this respect which are endorsed by this policy (see 6.2 below).

7 Protection of Children from Harm

The following details and measures are intended to address the need for the protection of children from harm; this includes emotional and physical harm which may be associated with licensed premises and certificated club premises (for example the exposure too early to strong language and sexual expletives, eg in the context of film exhibitions or where adult entertainment is provided). It is intended that the admission of children to premises holding a premises licence or club premises certificate should normally be freely allowed without restricting conditions (unless the 2003 Act itself imposes such conditions or there are good reasons to restrict entry or to exclude children completely).

- 7.1.1 Licensees should note the concern of the authority that drink related disorder frequently involves under 18's. To prevent illegal purchases of alcohol by such persons, all licensees should work with a suitable 'proof of age' scheme and ensure that appropriate identification is requested prior to entry and when requesting alcohol, where appropriate. Appropriate forms of identification are currently considered to be those recommended by police, trading standards officers and their partners in the Licensing Strategy Group (e.g. passport, photo driving licence or pass card).
- 7.1.2 It is the licensing authority's expectation that all staff responsible for the sale of intoxicating liquor receive information and advice on the licensing laws relating to children and young persons in licensed premises. Licensed premises staff are required to take reasonable steps to prevent under-age sales. The licensing authority will not seek to limit the access of children to any premises unless it is necessary for the prevention of emotional or psychological harm to them. Each application will be considered on its own merit but particular areas that will give rise to concern in respect of children are to be found in section 7.1.4 below.

7.1.3 To reduce alcohol-induced problematic behaviour by under 18 year olds, to enforce underage purchase and drinking laws and to assist in the protection of children from harm, the licensing authority supports the following measures:-

- a) Police should exercise powers (Confiscation of Alcohol (Young Persons) Act 1997) to remove alcohol from young people on the street
- b) Police and trading standards should implement test purchasing to reduce sales to under 18s in on and off sales licensed premises
- c) Further take-up of proof of age schemes will be promoted
- d) In-house, mystery shopper type schemes operated by local businesses will be supported
- e) Providers of events specifically catering for unaccompanied children should consider whether all staff at such events need to be DBS checked.

7.1.4 The licensing authority will not seek to require that access to any premises is given to children at all times – under normal circumstances this will be left to the discretion of the licensee. The following areas give rise to concern in respect of children, who will normally be excluded from premises:

- where there have been convictions for serving alcohol to minors or with a reputation for underage drinking.
- with a known association with drug taking or dealing.
- where there is a strong element of gambling on the premises.
- where entertainment of an adult or sexual nature is commonly provided.
- where premises are used primarily or exclusively for the sale and consumption of alcohol and there is little or no seating for patrons.

Options may include:

- limitations on the hours when children may be present.
- age limitations (below 18).
- limitations or exclusions when certain activities are taking place.
- requirements for an accompanying adult.
- full exclusion of people under 18.

7.1.7 Trading standards and the police undertake ongoing enforcement operations around under-age sales and test purchasing. Sussex Police and BCRP undertake work concerning proxy purchases and counterfeit ID as part of the partnership support work with Community Safety and Trading Standards.

7.1.8 Trading standards have a programme of business support including training for local businesses to avoid under-age sales.

8 Integration of Strategies

8.1.1 The licensing authority shall secure the proper integration of this policy with local crime prevention, planning policy, transport, tourism and cultural strategies by:-

- Liaising and consulting with the Sussex Police, Community Safety Forum, Sustainability Commission representatives and following the guidance in community safety and crime and disorder strategy
- Liaising and consulting with Public and Alcohol Programme Board
- Liaising and consulting with the East Sussex Fire & Rescue Service
- Liaising and consulting with the Local Strategic Partnership, Safety Advisory Group (Emergency Planning) and Equalities and Social Justice Consultation Forum
- Liaising and consulting with the Planning authority
- Liaising and consulting with the Highways authority
- Liaising and consulting with local business and business associations. Having regard to any future documents issued relating to the Private Security Industry Act 2001, for example liaison or information sharing protocols
- Liaising and consulting with the Trading Standards Team, for example with regard to test purchasing codes of practice

8.1.2 In line with statutory requirements and the council's Inclusion Policy, the Licensing Authority shall have due regard to the need to eliminate unlawful discrimination, and to promote equality of opportunity and positive relations between persons of diverse backgrounds, for example communities of interest such as: lesbian, gay, bisexual and transgender people; disabled people; racial and ethnic groups; religious and faith groups.

8.1.3 This policy supports the aims of the tourism strategy, recognising the benefits for the tourism economy of creating a safer and more attractive city centre and improving competitiveness with other European cities. The Licensing Committee should receive any reports relevant to the needs of the local tourist economy and the cultural strategy for the area to ensure that it considers these matters.

8.1.4 The Licensing Committee should receive relevant information relating to the employment situation of the area and the need for new investment and employment where appropriate.

8.1.5 Specific conditions may be attached to premises licences to reflect local crime prevention strategies. Such conditions may include the use of closed circuit television cameras, use of the NightSafe radio system or accredited scheme, the provision and use of shatterproof drinking receptacles, drugs and weapons search policy, the use of registered door supervisors, specialised lighting requirements, hours of opening. Certificates issued to club premises shall reflect local crime prevention strategies and may include any or all of the requirements listed above.

- 8.1.6 The licensing authority will have regard to the need to disperse people quickly and safely from the city centre to avoid concentrations which may produce disorder and disturbance.

APPENDIX A – Licensing Best Practice Measures

Best Practice Measures to be included for consideration, in particular in SSA:

Matters that would normally be expected in operating schedules:

- the adoption of a policy (e.g. Challenge 25) with acceptable proof of ID as per existing Statement of Licensing Policy
- all off sales to be made in sealed containers for consumption away from the premises
- a smoking policy which includes an assessment of noise and litter created by premises users
- the use of plastic or polycarbonate drinking vessels and containers, especially in outside areas or after specified hours
- a policy in relation to searching customers and for drugs, weapons, seized or lost and found property
- use of a refusals book for registering attempts to buy alcohol by underage persons or refusals to those intoxicated
- the installation of a digital CCTV system by liaison with, and to a standard approved by, Sussex Police
- policies for dispersal of customers which may include signage regarding taxi services' telephone numbers and advice to respect neighbours and minimize noise

Items to which positive consideration would be given:

- membership of Business Crime Reduction Partnership, Pubwatch, Neighbourhood Watch or similar schemes
- use of 'Night Safe' radio system or similar accredited scheme
- regular training and reminders for staff in respect of licensing legislation, policies and procedures; records of which should be properly recorded and available for inspection
- records of regular checks of all parts of the premises in relation to drug use
- systems in place to ensure details of barred clients are exchanged with other operators
- giving an agreed minimum notice of special events (screening of major sports events, birthday parties, adult entertainment, etc.) to relevant authorities and use of appropriate additional measures at such events

Recommend best practice for both on and off premises

- Staff must be aware of the risk of the problem of proxy sales and offer assistance to responsible authorities to deter offences
- Signage on premises should set out legal duties
- Voluntary restriction of high strength alcohol – operating schedules may be used to limit high ABV beers and ciders

- Staff training – in addition to personal licence holders training, staff must be adequately trained for duties
- Challenge 25 would be the norm, particularly in the off-licence trade
- Signage – proxy sale – deterrence

5. FINANCIAL & OTHER IMPLICATIONS:

Financial Implications:

- 5.1 The Licensing Act 2003 provides for fees to be payable to the licensing authority in respect of the discharge of their functions. The fee levels are set centrally at a level to allow licensing authorities to fully recover the costs of administration, inspection and enforcement of the regime.

Finance Officer Consulted Michael Bentley

Date: 27/04/21

Legal Implications:

- 5.2 The licensing authority must act to promote the four licensing objectives which are:
- The prevention of crime and disorder
 - Public safety
 - The prevention of public nuisance
 - The protection of children from harm

The licensing authority must have regard to its statement of licensing policy and the guidance issued by the Secretary of State in carrying out its functions.

Lawyer Consulted: Rebecca Sidell

Date: 29/04/21

Equalities Implications:

- 5.3 Diversity is valued and strong, safe communities are vital to future prosperity. Licensing policy aims to protect children from harm including sale and supply of alcohol to children.

Sustainability Implications:

- 5.4 Licensing policy aims to prevent public nuisance and develop culture of live music, dancing and theatre.

SUPPORTING DOCUMENTATION

Appendices:

1. Appendix A – Section 18 (operating schedule) of the Application
2. Appendix B – Plan of Premises
3. Appendix C – Representations
4. Appendix D – Map of Area

Documents in Members' Rooms

Brighton & Hove City Council, Licensing Act 2003: Statement of Licensing Policy 2021.

Home Office, Revised Guidance issued under section 182 of the Licensing Act 2003, April 2018.

Public Health Framework for assessing Alcohol Licensing. Annual Report – Ward. 5th edition. Public Health Intelligence. January 2019

Background Documents

Brighton & Hove City Council, Licensing Act 2003: Statement of Licensing Policy 2021.

APPENDIX A

Section 18 - Proposed Conditions for Application 2021/00754/LAPREN for 66 Lewes Road, Brighton

General:

1. Authorised staff employed by Sussex Police shall have free access to all parts of the licensed premises at all times licensable activity is taking place or when open to members of the public, for the purpose of inspection to ensure compliance with the terms and conditions of the premises licence and to ensure the promotion of the licensing objectives.
2. No beer, lager, perry or cider with an ABV of 6% or above shall be sold at the premises save that this shall not apply to premium beer, lager, perry or cider with an ABV of 6% or above such as craft or speciality brands or brands produced by a micro-brewery, or brands produced to commemorate a national or local event.
3. All alcohol will be displayed/stored in full sight of the serving counter.
4. Spirits will be stored and displayed behind the serving counter.

For the Prevention of Crime and Disorder:

5. a) Digital CCTV and appropriate recording equipment to be installed in accordance with Home Office Guidelines relating to UK Police Requirements for Digital CCTV System (PSDB Publication Number 09/05), operated and maintained throughout the premises internally and externally to cover all public areas. The system shall be on and recording at all times the premises licence is in operation.
- b) The CCTV cameras and recording equipment must be of sufficient quality to work in all lighting levels inside the premises at all times.
- c) CCTV footage will be stored for a minimum of 31 days.
- d) The management will give full and immediate cooperation and technical assistance to the Police in the event that CCTV footage is required for the prevention and detection of suspected or alleged crime.
- e) The CCTV images will record and display dates and times, and these times will be checked regularly to ensure their accuracy.
- f) Subject to GDPR guidance and legislation, the management of the premises will ensure that key staff are fully trained in the operation of the CCTV, and will be able to download selected footage onto a disk (or other electronic portable device acceptable to Sussex Police) for the police without difficulty or delay and without charge to Sussex Police.
- g) Any breakdown or system failure will be notified to the police immediately & remedied as soon as practicable.

- h) In the event of the CCTV system hard drive being seized as evidence as part of a criminal investigation by Sussex Police or for any other reason, the premises will be expected to install a replacement hard drive or a temporary replacement drive as soon as practicable.
6. a) An incident log will be maintained by the premises showing a detailed note of incidents that occur in the premises. The log will be inspected and signed off by the DPS (or a person with delegated authority) at intervals of no more than four (4) weeks.
- b) The log book should be kept on the premises and be available for inspection at all times the premises are open by authorised officers of the Licensing Authority or the police. An incident will be defined as being one which involves an allegation of a criminal offence.
- c) Feedback shall be given to staff to ensure these are used on each occasion that a refusal or incident occurs at the premises.
- d) Any refusals made for alcohol service e.g. underage, will also be recorded (either in electronic or written form) and feedback given to staff as relevant. The log will be kept for a minimum of twenty four (24) months.

For Public Safety: None

For the Prevention of Public Nuisance:

7. Notices will be displayed asking patrons to leave the premises quietly and to have respect for local residents

Protection of Children from Harm:

8. The premises will operate a "Challenge 25" policy whereby any person attempting to buy alcohol who appears to be under 25 will be asked for photographic ID to prove their age. The recommended forms of ID that will be accepted are passports, official Photographic Identity Cards issued by EU states bearing a hologram or ultraviolet feature, driving licences with a photograph, photographic military ID or proof of age cards bearing the 'PASS' mark hologram. The list of recommended forms of ID may be amended or revised with the prior written agreement of Sussex Police, the Licensing Authority and Trading Standards without the need to amend the licence or conditions attaching to it.
9. Signage advertising the 'Challenge 25' policy will be displayed in prominent locations in the premises.
10. A list of staff members who are authorised to sell alcohol on the premises shall be kept. This shall be endorsed by the DPS with the date such authorisation commences.
11. a) The Premises Licence Holder shall ensure that all staff members engaged or to be engaged, in selling alcohol at the premises shall receive the following induction training. This training will take place prior to the selling of such products:
- The lawful selling of age restricted products
 - Refusing the sale of alcohol to a person who is drunk

- Refusing the sale of alcohol for consumption off the premises to people who may have alcohol dependency issues
- b) Further verbal reinforcement/refresher training covering the above will be carried out thereafter at intervals not to exceed 8 weeks, with the date and time of the verbal reinforcement/refresher training documented.
- c) All such training undertaken by staff members shall be fully documented and recorded. All training records shall be made available to Sussex Police, officers of the local authority and officers from the Trading Standards team upon request.

APPENDIX B

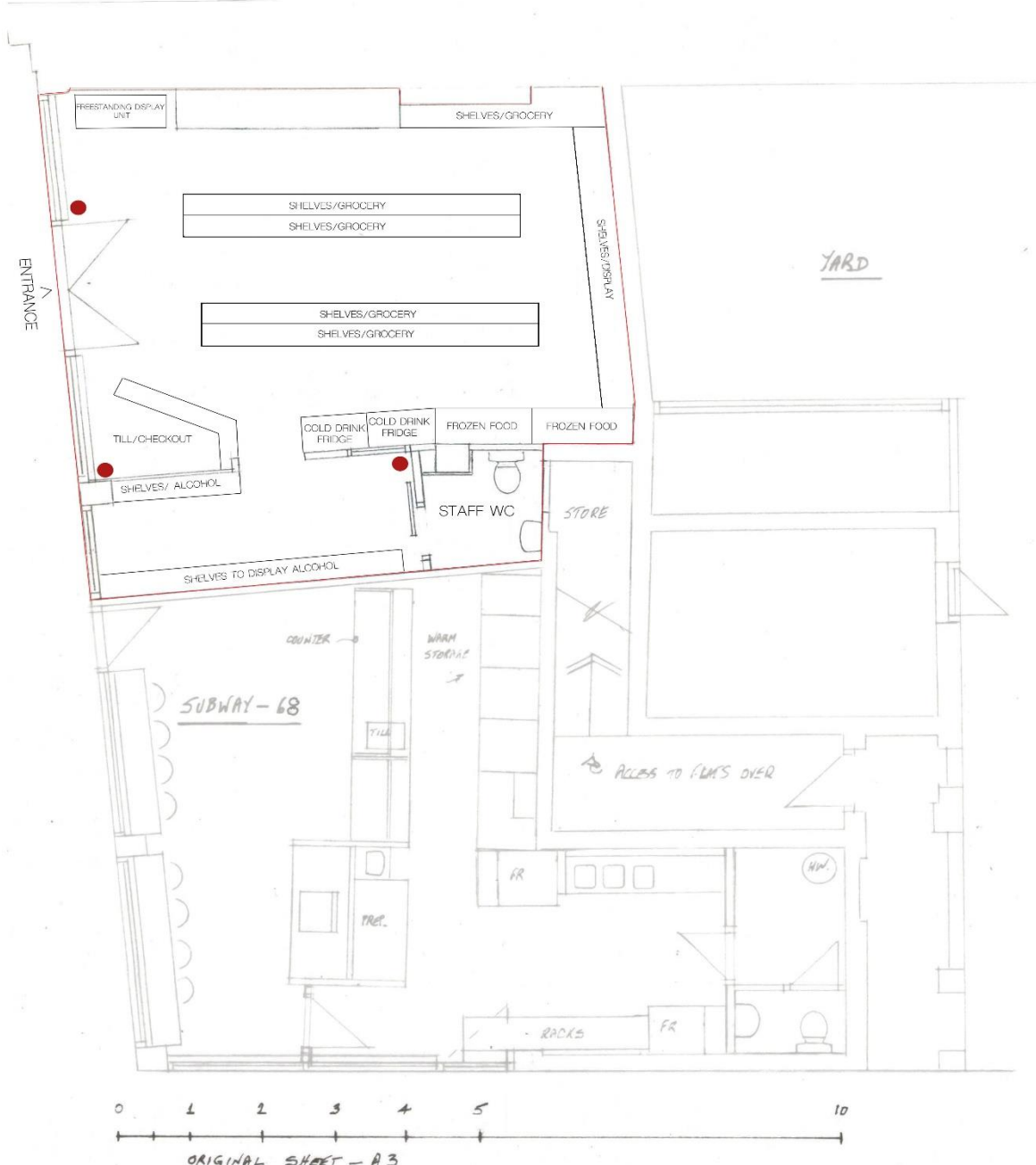

● FIRE EXTINGUISHERS/ FIRE BLAST 6LT FOAM

CAMPBELL CHARLES ASSOCIATES
 Building Surveyors and Designers
 2 ST. MARTINS PLACE, BRIGHTON BN2 3LE
 01273 604845 - yamancampbell@gmail.com
 Party Wall Specialists

66 - 68 LEWES RD. BRIGHTON		SCALE 1:50	DRAWING No.
PLAN - 66 AS EXISTING		DATE 24-09-2020	2043/S/1
		DRAWN CC	
CAMPBELL CHARLES ASSOCIATES		Tel: 01273 604845	
BUILDING SURVEYORS AND DESIGNERS		2 SAINT MARTINS PLACE, BRIGHTON BN2 3LE	

APPENDIX C

Police Station
John Street
Brighton
BN2 0LA

Tel: **REDACTED TEXT**

Email: **REDACTED TEXT**

14th April 2021

The Licensing Technical Support Officers
Environmental Health, Brighton & Hove City Council
Bartholomew House, Bartholomew Square
Brighton, East Sussex
BNI IJP

DML CON ENDS 19.04.21 VALID PCD, PPN & PCH (A)

Dear **REDACTED TEXT**

RE: APPLICATION FOR A NEW PREMISES LICENCE FOR 66 LEWES ROAD, BRIGHTON, EAST SUSSEX, BN2 3HZ UNDER THE LICENSING ACT 2003. 1445/3/2021/00754/LAPREN.

I write on behalf of the Chief Officer of Police for Sussex to raise a representation against the grant of the above application on the grounds that it will undermine the Licensing Objectives of the prevention of crime and disorder, the protection of children from harm and public nuisance. We also make reference to the Brighton & Hove City Council (BHCC) Statement of Licensing Policy (revised January 2021) and the Revised Guidance issued under section 182 of the Licensing Act 2003 (April 2018).

This is a proposed new licence application in an area of the City which is subject to a Special Policy adopted by Brighton & Hove City Council. The premises lies in the Special Stress Area (SSA) (as defined in the BHCC Statement of Licensing Policy) and seeks the following hours and licensable activities:

Sale by Retail of Alcohol (Off the premises)

Everyday: 09:00 – 23:30

Late Night Refreshment (Indoors)

Monday - Saturday: 23:00 – 00:00

Sunday: 23:00 – 23:30

Opening hours

Everyday: 09:00 – 02:00

Paragraph 3.2.1 of the Brighton and Hove City Council 2021 Statement of Licensing Policy describes the Special Stress area as:

“...the area of the city centre which borders the Cumulative Impact zone at 3.1.3 and which is deemed an area of special concern in terms of the levels of crime and disorder and public nuisance experienced within it. The area recommended for further monitoring and detailed guidance within the Special Policy...”

This premises lies within St. Peter’s and North Laine Ward which, as evidenced by the Brighton & Hove Public Health Framework for Assessing Alcohol Licensing (published January 2019), is ranked number 1 for Police recorded alcohol related incidents and criminal damage. This ward is also ranked number 2 for All violence against the person and All injury violence, demonstrating the higher risk to the Licensing Objective of the Prevention of Crime and Disorder in this area.

The licensing decision matrix on page 16 of the Council Statement of Licensing Policy (SoLP) suggests that new premises or premises licence variations asking for these licensable activities and hours are a ‘No’. While Paragraph 3.2.2 states that within the SSA “*applications will not be subject to the presumption of refusal*” it goes on to state that “*operators will be expected to pay special attention when drawing up their operating schedules and to make positive proposals to ensure that their operation will not add to the problems faced in these areas*”. While the applicant has made reference to the BHCC Statement of Licensing Policy (SoLP) within their application and recognised that their premises is located within an area of the city that is subject to Special Policy, they have not gone on to address any of the local concerns or offered particular reasoning as to why their application would be an exception to policy or why the SoLP matrix should be departed from.

Sussex Police acknowledge that the application has been revised during the consultation period and the hours being applied for reduced however, there are additional concerns around the gap between the cessation of licensable activities and closing time. There are questions around how staff will manage the risk of confrontation if alcohol sales cease at 23:30 but the shop remains open until 02:00. Further, what measures will be put in place to support staff in explaining to customers and refusing sales for this 2.5 hour period into the early hours of the morning? On a practical note, will alcohol be removed from the shop floor at 23:30 or covered for the remaining hours? None of these concerns have been addressed within the application as it stands.

There is also some confusion around the business model of this premises as Late Night refreshment is being applied for every day but only until 00:00 Monday to Saturday and 23:30 on Sunday. Again, this leaves a large gap between cessation of licensable activity and closing time. Sussex Police are aware that offering hot food and drink into the early hours encourages persons who may be under the influence of alcohol or drugs to remain in the area, which is heavily residential. This increases the risk of crime and disorder, anti-social behaviour and public nuisance.

Paragraph 14.40 of the Secretary of State's Guidance to the Licensing Act 2003 (April 2018) provides:

'In publishing a CIA a licensing authority is setting down a strong statement of intent about its approach to considering applications for the grant or variation of premises licences or club premises certificates in the area described... Applications in areas covered by a CIA should therefore give consideration to potential cumulative impact issues when setting out the steps that will be taken to promote the licensing objectives.'

The applicant has offered limited information under Section 18 of their application with minimal workable conditions and Sussex Police do not believe these go far enough to help mitigate any potential risk in this area of the City. The conditions offered fall far short of the current city wide expected standard and there is no mention of any crime prevention measures such as SIA risk assessment/provision or indeed staff training around the sale of alcohol or a Challenge 25 policy. Sussex Police do not believe at this time the application in its current form addresses the concerns raised and therefore is at risk of undermining the prevention of crime & disorder, the protection of children from harm and public nuisance Licensing Objectives. Sussex Police additionally contend that the carrying on of additional licensable activity and the hours applied for at these premises will add to the existing negative cumulative effect in an area already saturated with licensed premises.

Therefore, Sussex Police invite the Licensing Authority to seriously consider refusing this application.

Yours sincerely,

REDACTED TEXT

REDACTED
Licensing Authority
Brighton & Hove City Council
Bartholomew House
Bartholomew Square
Brighton
BNI IJP

Date: 19th April 2021
Our Ref: REDACTED
Phone: REDACTED
e-mail: REDACTED

DML CON ENDS 19.04.21 VALID PCD & PPN (B)

Dear REDACTED,

Licensing Act 2003 – Licensing Authority representation against the application for a Premises Licence (Ref: 2021/00754/LAPREN)
Re: 66 Lewes Road, Brighton, BN2 3HZ

I refer to the application made by Ms Esra Baser for a new Premises Licence for 66 Lewes Road, Brighton, BN2 3HZ.

The amended application states; *'The premises includes a section as highlighted on the plan shows the allocation of the alcohol will be held at a sectioned area of the premises where the till will be situated so the supervisors can assist everyone with selecting/buying alcohol if necessary. As having previous history of selling alcohol at the premises with a valid license that has been lapsed due to acceptance of family commitments (health issue) we are fully aware of the statement of licensing policy within the designated Special Stress Area, we understand and willing to commit to all the set outcomes. As we are aware that the bounded area will be kept under review and we are keen to work with the third parties in the future if necessary to provide appropriate operation within the SSA.'*

The application now seeks the licensable activity of the Sale of Alcohol 'Off' the premises from 07.30-23.30 hrs Friday and Saturday and 07.30 – 23.00 hrs Sunday – Thursdays, with the same opening hours.

I have concerns about this application and make a representation on the grounds of the Prevention of Crime and Disorder, the Prevention of Public Nuisance and that this application falls within our Special Stress Area (SSA) and is contrary to our Statement of Licensing policy (SoLP).

As mentioned above, this premises sits within the Special Stress Area, which, as stated in our SoLP on pages 15-17, is deemed an area of special concern in terms of the levels of crime and disorder and nuisance experienced within it. 3.2.3 of our SoLP states that new and variation applications for premises within the SSA will not be subject to the presumption of refusal, but operators will be expected to pay special attention when drawing up their operating schedules and to make positive proposals to ensure that their operation will not add to the problems faced in these areas.

The Council's SoLP includes a Matrix approach for licensing decisions with provisions for a terminal hour for all classes of licensed premises in a particular area. The Matrix Model recognises the diverse operation and different risks presented by different classes of licensed premises. The SoLP provides a vision of what the Licensing Authority would like to

see within its area and gives an indication of likelihood of success or otherwise to investors and local businesses making applications. Each application is still considered on its individual merit and there is discretion to depart from the Matrix approach policy in exceptional circumstances.

The decision-making Matrix on page 18 of the Council's Statement of Licensing Policy states 'No' to Off-Licences' in the Special Stress Area.

The premises is in the Special Stress Area and is located in the electoral ward of St. Peter's and North Laine, which according to our Public Health Framework for Assessing Alcohol Licensing (5th edition- January 2019) is ranked the worst out of 21 wards under Crime and Disorder data for Police recorded alcohol related incidents and Criminal Damage and second worst for; All violence against the person, All injury violence, Non-injury assault and Sexual offences.

Under the Health data St. Peter's and North Laine ward ranks worst for Increasing Risk or higher risk drinking and Alcohol suspected ambulance call outs and third worst for A&E attendances with a record of alcohol.

I am making this representation as a guardian of our policy which this application is contrary to, so that the panel may determine the outcome of the application.

Yours sincerely

REDACTED

APPENDIX D



